

INFORMATION – WIND/PERCUSSION/STRING EVENTS

All times are E.S.T. (Indianapolis time)

NOTICE:

All woodwind, brass, and percussion events will be held at North Central High School. **All String events will be held at Northview Middle School, adjacent to North Central High School.**

FOOD SERVICE:

As a courtesy to our host school, absolutely NO FOOD OR DRINKS are permitted to be brought into the school. Food service is available in the Cafeteria beginning at 8:00 a.m. NO FOOD OR DRINK SHOULD BE TAKEN OUT OF THE CAFETERIA!

MEDALS:

All performers receiving a Gold, Silver, Bronze, Participation, or Comment Only rating should take their comment sheet to one of the award distribution tables located throughout the building. Awards and ribbons will be distributed at these locations. DO NOT COME TO HEADQUARTERS FOR AWARDS!

PROGRAMS:

A printed program will NOT be available at the site. If you desire a printed schedule, please print out the schedule available on this website as needed.

ACCOMPANIST MEDALS; PATCHES AND YEAR ROCKERS:

Accompanist Medals, State Solo & Ensemble Patches, and Rockers will be available for purchase at NCHS in the Student Center located in front of the auditorium, and in the Student Center lobby at NMS. Costs are \$3.00 for Accompanist Medals, \$2.00 for Patches and \$1.00 for year 2017 Rockers.

SCHEDULE CONFLICTS:

Minor schedule conflicts can usually be resolved at the performance room. Please notify the doorkeeper of such problems so the room may continue with the schedule. Performers are urged to continually check with the doorkeeper, as an opening might allow for a slightly earlier performance time.

EVENT HEADQUARTERS:

The Event Headquarters is located at North Central in Room B125 near the auditorium. Emergency calls may be directed to 317/259-5355 ext. 45318.

LOST AND FOUND:

Event Headquarters will serve as the location for lost and found items.

T-SHIRTS:

Specially designed ISSMA long-sleeve t-shirts for State Solo & Ensemble are available for purchase at NCHS in the Student Center located in front of the auditorium, and in the Student Center lobby at NMS. Cost is \$20.00 for S, M, L, XL, and XXL.

MAPS:

Directors: **Give your students a copy of the building maps as well as schedules.**

PARKING:

Parking is available on the south, east and west sides of North Central, behind the JEL Career Center and on the north and south side of Northview Middle School. Parking is prohibited on the West side of Northview M.S. Buses and instrument trucks will be sent to an area behind the school after unloading.

(continued)

EMERGENCY REPAIR SERVICE:

Paige's Music of Indianapolis is providing complimentary emergency instrument repair service at North Central High School and Northview Middle School.

COLLEGE AND UNIVERSITY BOOTHS

A feature at this year's State Solo & Ensemble Festivals is the presence of representatives of many Indiana College and University Schools of Music in the auditorium lobby area at North Central and in the student center at Northview Middle School.

PERCUSSION INFORMATION

PERCUSSION EQUIPMENT:

A set of four tympani will be provided in the tympani solo room and the percussion ensemble room. There will also be one marimba available in the solo room and one marimba available in the large ensemble room. Percussion equipment must use **Entrance 28** on the **west** side of the school for loading and unloading.

PERCUSSION WARM-UP/STAGING:

The South Gym is the percussion equipment storage and warm-up area. In the interest of noise control, ISSMA is providing practice pads that are to be used by snare drum, drum set, multi percussion, and multi tenor solos for warming up in this area. Playing in the gym area without practice pads is prohibited. Mallet solos, timpani, and percussion ensembles may also warm up briefly in this area. Please limit all warm-up to the South Gym and for no more than 30 minutes prior to scheduled performance times.

Solos

All percussion solos (Event #'s 099, 100, 102, 103, 104, and 105) should check in with the ISSMA Officials at the table located **inside the South Gym** (Warm Up area) **at least 30 minutes** prior to their scheduled performance times. When checking in, soloists should be prepared to tell the officials their name, their event (snare drum, timpani, etc...), and time of performance. This is also where practice pads are signed in and out for warm up.

Ensembles (PLEASE NOTE CHECK-IN/STAGING PROCEDURES)

In an effort to alleviate congestion and overcrowding in the hallways outside of the Percussion Ensemble performance rooms, a check in/staging procedure has been instituted for all Percussion Ensembles (Event #'s 110, 111, 112, 113, and 115).

A representative from each participating ensemble (director, instructor, student member) must check in with the ISSMA Officials at the table located **outside the South Gym in the "L" Hallway at least 30 minutes** prior to their scheduled performance time. When checking in, the representative should be prepared to tell the officials the school name, event (Mallet Ensemble 3-6, etc...) and time of performance for their ensemble. Each ensemble will receive an entry card from the ISSMA Official that will allow their ensemble access to the performance hallway and rooms. **No ensemble will be admitted to these areas without this entry card.** After checking in, ensembles will be allowed to stage in the hallway area outside the South Gym **no sooner than 20 minutes** before their performance time. Ensembles will be released by the ISSMA Officials to proceed to their performance room **10 minutes** before their scheduled performance time.

Any ensemble not checking in by their assigned performance time will forfeit their spot in the schedule and must be worked in at the next available opening by the ISSMA Officials at the check in table. Any ensemble wishing to perform before their assigned time due to other performance conflicts must report to the check in table and present their request in writing from the director/instructor to the ISSMA Officials. The Officials will attempt to work that ensemble in at the first available opening.

(continued)

FACILITY:

ISSMA APPRECIATES THE USE OF NORTH CENTRAL HIGH SCHOOL AND NORTHVIEW MIDDLE SCHOOL FOR THIS EVENT.

WE EXPECT DUE RESPECT FOR CLASSROOMS, RESTROOMS AND HALLWAYS.

**THIS IS A NON-SMOKING CAMPUS
(INSIDE AND OUTSIDE).
NO TOBACCO PRODUCTS MAY BE USED
WHILE ON SCHOOL GROUNDS.**

**PLEASE CONSUME ALL FOOD AND DRINK IN THE
CAFETERIA ONLY. WITH THE EXCEPTION OF WATER,
PLEASE DO NOT CARRY FOOD OR DRINK ITEMS
TO OTHER PARTS OF THE BUILDING.**

**IN ACCORD WITH FEDERAL COPYRIGHT LAW,
THERE ARE NO PHOTOCOPYING SERVICES AT
THIS SITE.**

PLEASE NOTE: There is NO ATM located in either school building.



North Central High School
 Metropolitan School District of Washington Township
 1801 East 86th Street, Indianapolis, IN 46240

= Medal Tables

First Floor

Elevators located in Atrium
 (near Door 1)
 and on East side of Auditorium

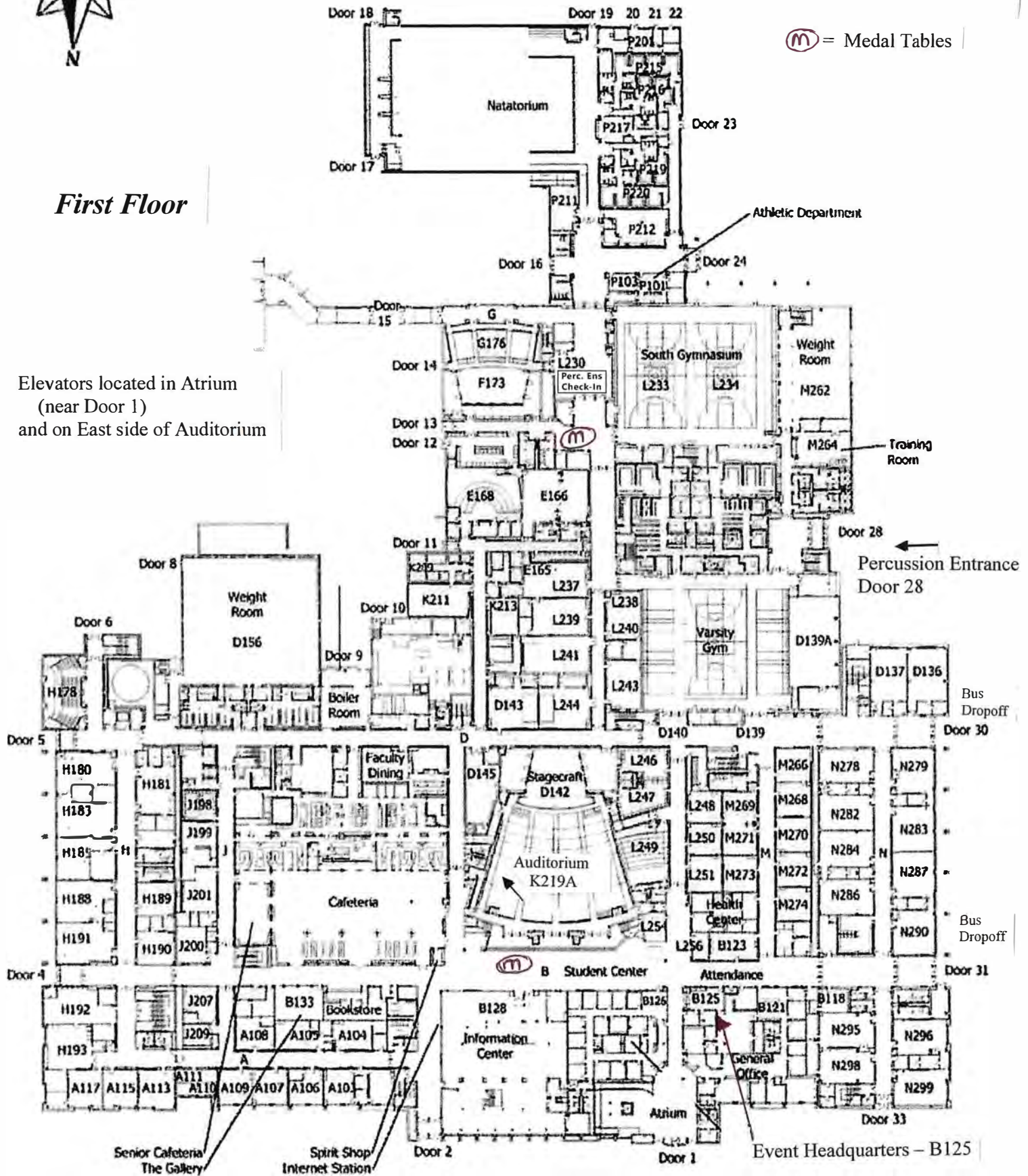



North Central High School
Metropolitan School District of Washington Township
1801 East 86th Street, Indianapolis, IN 46240

Second Floor

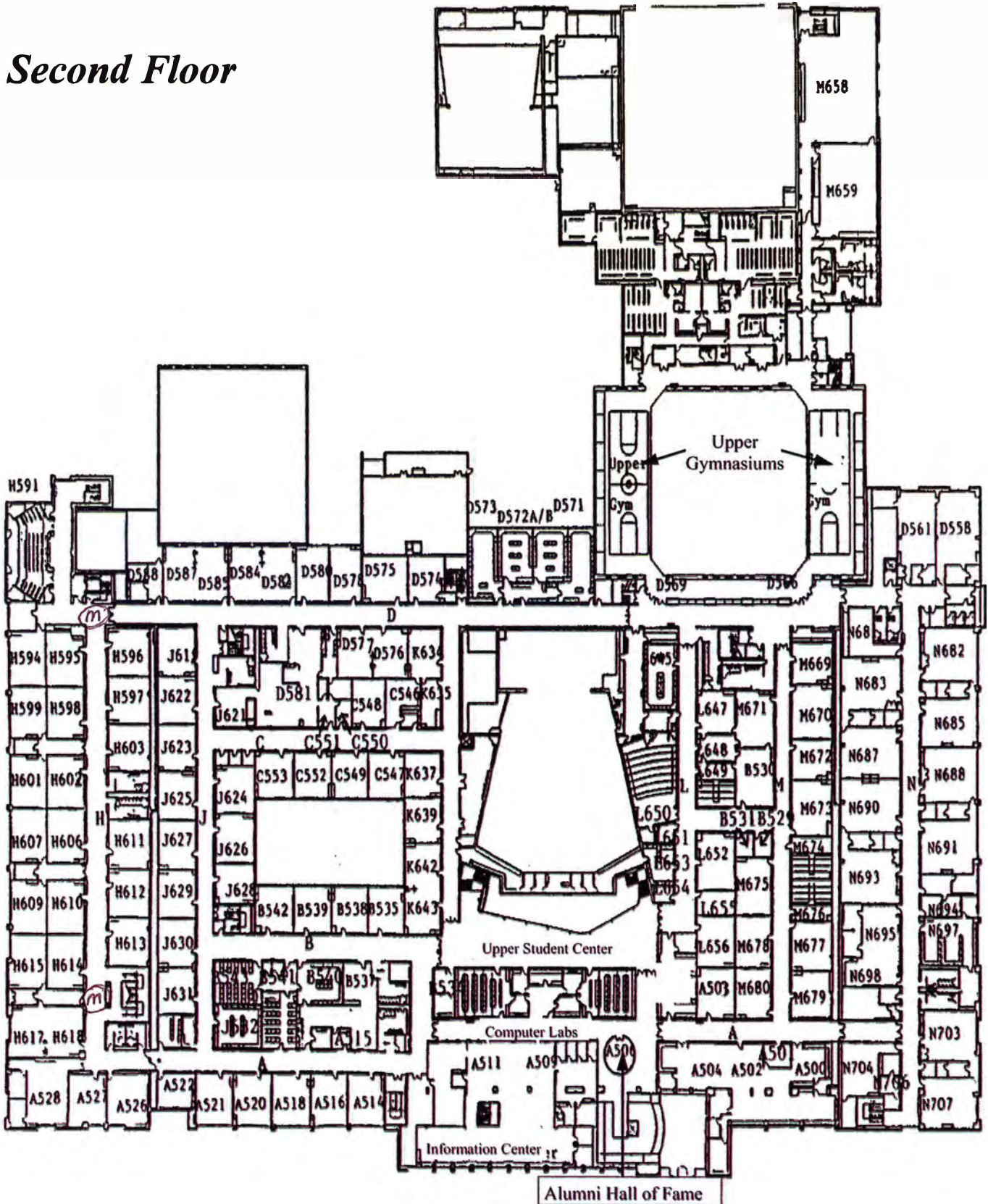

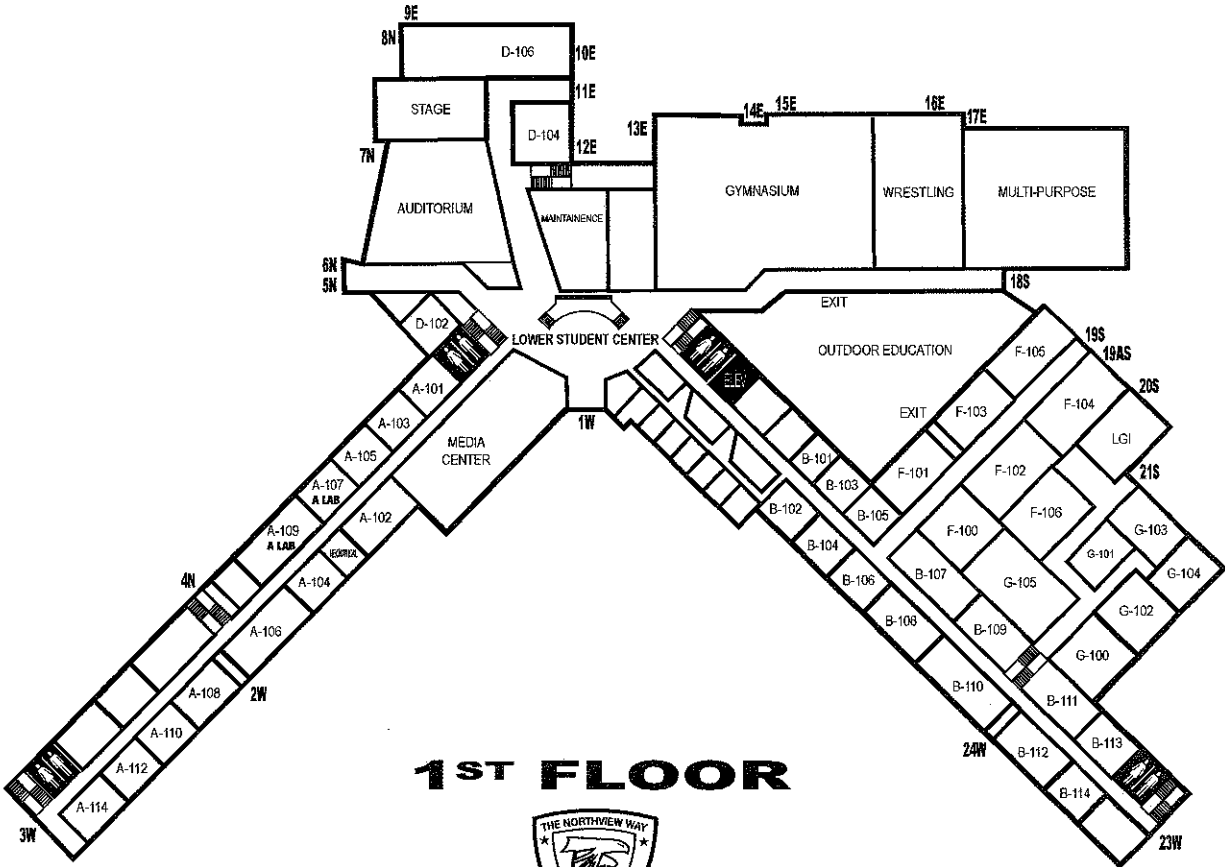
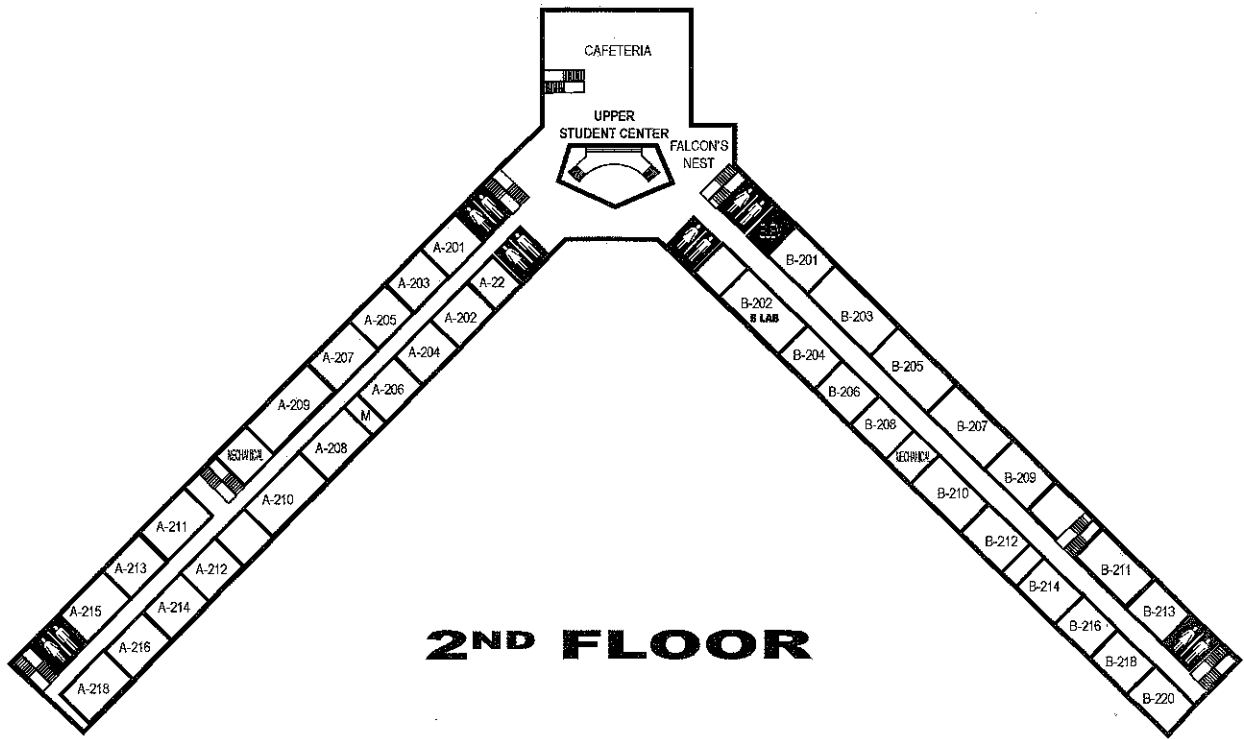

NORTHVIEW MIDDLE SCHOOL

Name	Event	Performance Time	Performance Room	Warm-up Room
Jessica Chastain	Violin Solo	9:26am	B208	Large Gym
Hannah Chung	Violin Solo	8:46am	B210	"
Emily Otten	Violin Solo	1:40pm	B210	"
Joyce Yoon	Violin Solo	9:42am	B212	"
Karen Jin	Violin Solo	3:02pm	B212	"
Vi Nguyen	Violin Solo	10:48am	B111	"
Phoebus Yang	Violin Solo	1:56pm	A105	"
Britten Ensemble	Large String Ensemb	9:33am	F100	"